

Garment Steamer

User Manual

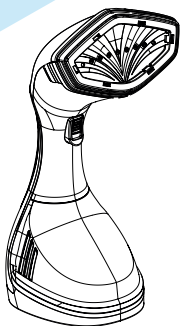

STM 4116 B

EN | DE | FR | TR | ES
PL | RO | IT | AR

01M-8817073200-3419-01

beko

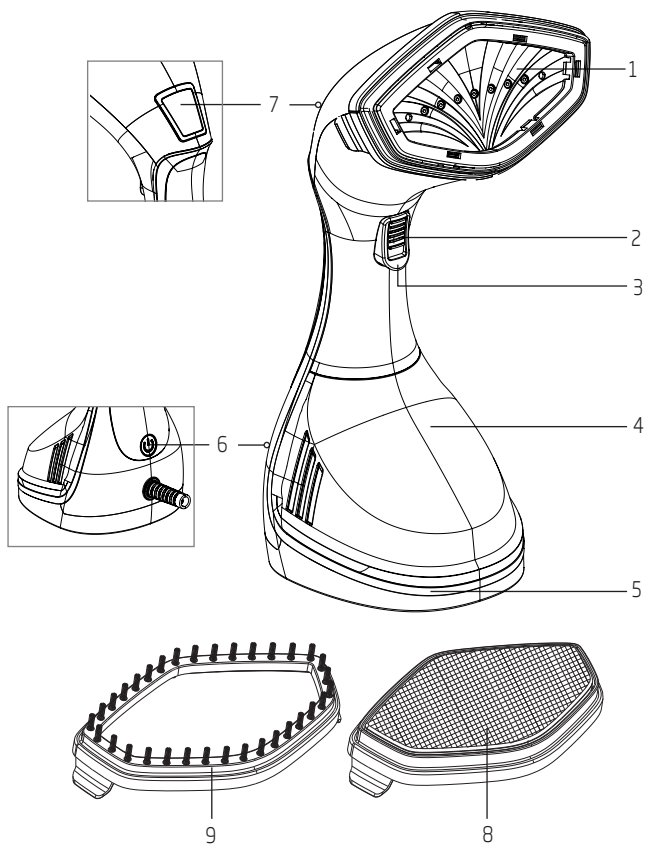

CONTENTS

ENGLISH	8-17
DEUTSCH	18-31
FRANÇAIS	32-42
TÜRKÇE	43-56
ESPAÑOL	57-69
POLSKI	70-82
ROMANIAN	83-95
ITALIANO	96-108

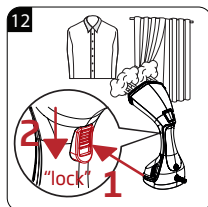
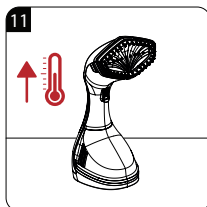
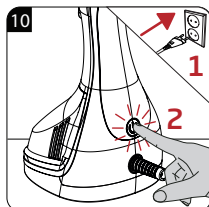
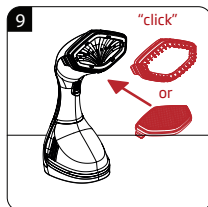
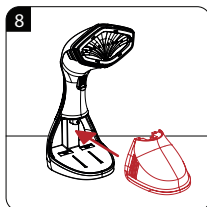
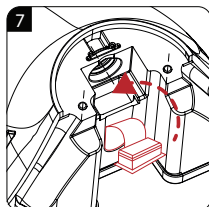
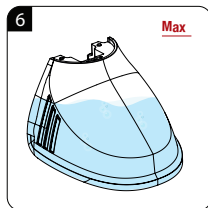
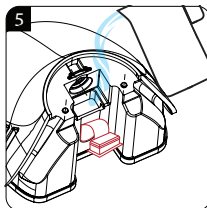
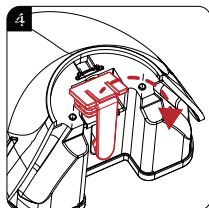
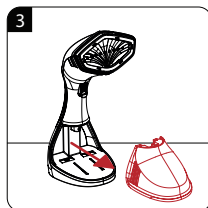
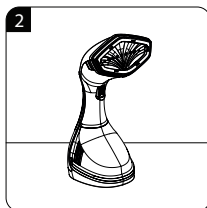
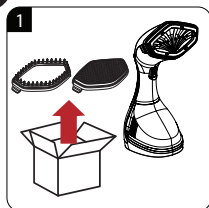

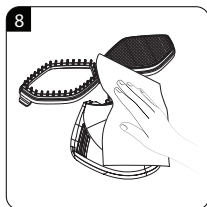
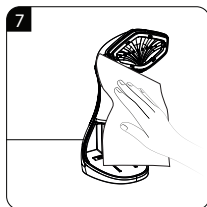
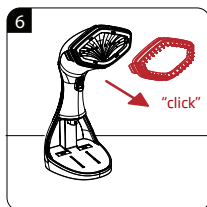
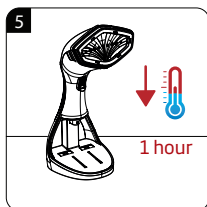
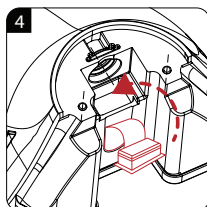
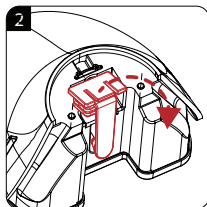
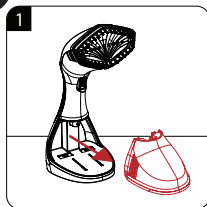
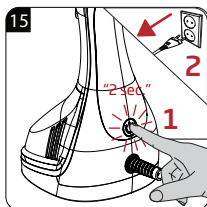
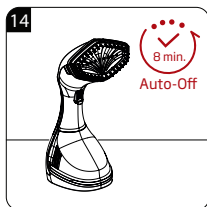
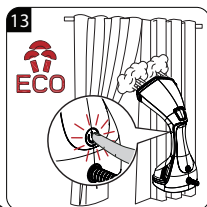



		
EN	OPERATION	CLEANING AND CARE
DE	BETRIEB	REINIGUNG UND PFLEGE
FR	FONCTIONNEMENT	NETTOYAGE ET ENTRETIEN
TR	KULLANIM	TEMİZLİK VE BAKIM
ES	FUNCIONAMIENTO	LIMPIEZA Y CUIDADOS
PL	OBSŁUGA	CZYSZCZENIE I KONSERWACJA
RO	UTILIZARE	CURĂ AREA ȘI ÎNGRIJIREA
IT	UTILIZZO	PULIZIA E CURA
AR	التشغيل	التنظيف والعناية

Please read this user manual first!

Dear Customers,

Thank you for selecting a Beko product. We hope that you get the best results from your product which has been manufactured with high quality and state-of-the-art technology. Therefore, please read this entire user manual and all other accompanying documents carefully before using the product and keep it as a reference for future use. If you handover the product to someone else, give the user manual as well. Follow all warnings and information in the user manual.

Meanings of the symbols

Following symbols are used in the various section of this manual:



Important information and useful hints about usage.



WARNING: Warnings for dangerous situations concerning the safety of life and property.



WARNING: Warning for hot surfaces.



Risk or burning and scalding due to steam.

1. Face plate
2. Steam lock button
3. Steam button
4. Water tank
5. Water tank housing
6. Power switch
7. Display screen
8. Net brush
9. Fabric brush

Display screen

	No water in the tank
	Auto shut off indicator
	Maximum level of steam
	Energy saving steam level

Technical data

Power supply: 220-240 V~, 50-60 Hz

Power: 1400-1600 W

Technical and design modification rights are reserved.

The values which are declared in the markings affixed on your appliance or the other printed documents supplied with it represent the values which were obtained in the laboratories pursuant to the pertinent standards. These values may vary according to the usage of the appliance and ambient conditions.



This product has been produced in environmentally-friendly, state-of-the-art facilities.

Conforms to the WEEE Directive.



It does not contain PCB.

1 Important safety and environmental instructions

This section contains safety instructions that will help protect from risk of personal injury or material damage.

Failure to follow these instructions invalidates the granted warranty.

1.1 General safety

- This appliance complies with the international safety standards.
- This appliance can be used by children who are at the age of 8 and above and by people who have reduced physical, perceptual or mental abilities or by people who are deficient in terms of experience and knowledge as long as they are supervised and given the instructions regarding the safe use of the appliance and dangers encountered. Children should not play with the appliance. Cleaning and user maintenance procedures should not be performed by children unless they are supervised by an older person.

1 Important safety and environmental instructions

- Unplug the appliance and wait for it to cool before removing or reinstalling the brush accessory.
- Do not put the appliance on its head piece when it is in use or plugged in. Place the appliance on a stable and flat surface.
- Be careful because of the hot steam emission while the appliance is in use.
- The appliance may get heated because of the hot steam emission and this may cause burns if you contact it.
- If the appliance is dropped or leaks water or has other failures, contact the authorised service. Do not use the appliance until it is repaired.
- The appliance is not suitable for outdoor use.
- When the appliance is in use or left to cool, keep the appliance and power cable out of the reach of children under 8 years old.

1 Important safety and environmental instructions

- Only use the original parts or parts recommended by the manufacturer.
- Do not attempt to dismantle the appliance.
- Your mains power supply should comply with the information given on the rating plate of the appliance.
- The mains supply of the appliance should be secured with a 30 mA fuse minimum.
- Use the appliance with a grounded outlet.
- Do not use the appliance with an extension cable.
- Do not pull the power cable when unplugging the appliance.
- Unplug the appliance before cleaning or filling water.
- Do not wrap the cable around the appliance.
- Do not touch the appliance or its plug with damp or wet hands when the appliance is plugged in.

1 Important safety and environmental instructions

- Do not use the appliance in or near the areas where combustible or inflammable places and materials exist.
- If you keep the packaging materials, store them out of the reach of children.
- Do not leave the appliance unattended while appliance is plugged in.
- Perform water filling according to the instructions.
- Do not use the appliance if the power cable or the appliance itself is damaged. Contact an authorised service.
- Unplug the appliance during water filling / draining or when not in use.
- Do not hold the steam to parts containing electrical components such as inside of the furnaces.
- Do not remove the water bin during use.

1 Important safety and environmental instructions

1.2 Compliance with WEEE Directive and Disposing of the Waste Product

This product complies with EU WEEE Directive (2012/19/EU). This product bears a classification symbol for waste electrical and electronic equipment (WEEE).



This symbol indicates that this product shall not be disposed with other household wastes at the end of its service life. Used device must be returned to official collection point for recycling of electrical and electronic devices. To find these collection systems please contact to your local authorities or retailer where the product was purchased. Each household performs important role in recovering and recycling of old appliance. Appropriate disposal of used appliance helps prevent potential negative consequences for the environment and human health.

1.3 Compliance with RoHS Directive

The product you have purchased complies with EU RoHS Directive (2011/65/EU). It does not contain harmful and prohibited materials specified in the Directive.

1.4 Package Information



Packaging materials of the product are manufactured from recyclable materials in accordance with our National Environment Regulations. Do not dispose of the packaging materials together with the domestic or other wastes. Take them to the packaging material collection points designated by the local authorities.

2 Operation

2.1 Intended use

This appliance is intended only for household use, removing the creases on your clothes and for various textile products including curtains; it is not suitable for professional use.

2.2 Before first use

- Remove any sticker or protective cover from the steam head.
- Unwind and straighten the cord before use.
- When operating the garment steamer for the first time, allow it to steam for a few minutes. this will remove any impurities and odours that might have been left by the manufacturing process.
- When operating the garment steamer for the first time, you may want to try the steamer on an old piece of fabric before steaming your garment.



WARNING: To avoid an electrical circuit overload, it is recommended that no other appliances are plugged into the same circuit as your garment steamer when it is in use.



When unpacking the garment steamer, check to see you have received all the items listed in the parts list, before discarding the packaging.

2.3 Assembling/operating your garment steamer



- Do not exceed the MAXIMUM level when filling the water tank.
- Press the power button (6), the display screen icons will blink for once, and then only the steam level icon will blink indicating that the device is heating up. Allow the device to preheat before use. The device is ready for use when the steam icon is lit continuously.
- You may switch between steam levels by pressing the power button (6).
- The garment steamer has an intelligent automatic power off function. When the user stops operating this product for more than 8 minutes of time, the internal control circuit will cut off power supply, and the product will enter standby mode to ensure safety and to save energy. At the same time, the "auto shut off indicator" blinks.

2 Operation



When there is not enough water in the tank, the pump will automatically stop working within 25-35 seconds (Noise is normal during this process). Finally, "No water in the tank" icon blinks.

2.4 How to steam your garment

It can be used on most fabrics as long as the fabric is hanging or where the garment steamer can be easily used in an upright position moving over the fabric in an up and down motion.



- The garment steamer is designed to be used in an upright position on hanging garments.
- Check garment pockets are empty and turn-ups, such as cuffs and hems, are down.
- We recommend you do not steam over metal accessories. Be cautious and steam around the metal accessories.
- You will feel vibrations and hear a subtle humming sound while steaming; this is normal, steam facing away from you and in an upright position.
- Ensure that the fabric to be steamed is being stretched whilst steaming for best results.



WARNINGS:

- The garment steamer generates high temperatures of steam. Do not touch the steam head, make sure the steamer is facing away from you in an upright position.
- For better results, use fabric brush (9) attachment. However, for delicate fabrics, use net brush (8) to prevent pilling.

2.5 To steam curtains

- Wash and dry curtains as directed, according to the fabric type.
- Hang the curtains and steam when they are hanging in place.

2 Operation

2.6 To steam upholstery

- The garment steamer can be used to help freshen up upholstery, slipcovers and cushions. Before steaming, always test on a small area of the subject that is not visible.



- For better results when removing stubborn creases, continuously steam over the selected area until creases are removed.
- Only use attachments or accessories provided.
- If the unit becomes noisy with a loud humming sound and no steam is being generated, check the water level in the water tank. This may indicate that the garment steamer is out of water, and it needs to be refilled.



WARNINGS:

- If garment has metal accessories, be cautious and do not have garment steamer directly over the metal as this may discolour the metal.
- Always unplug the garment steamer before attaching or detaching the brush.
- Do not use the garment steamer directly on the body, animals, or while wearing the garments.

3 Cleaning and maintenance

3.1 Cleaning and care



- Never use gasoline, solvent and abrasive cleaning agents or hard brush to clean this appliance.
- Do not put the garment steamer in water or any other liquid.
- Do not drop, throw or try to bend the steamer.
- Do not attempt to disassemble the appliance.
- The garment steamer is designed for household use only and to be used with normal tap water. Do not put perfume, vinegar or other chemicals in the tank. The appliance is not designed to work with these chemicals.
- Always empty the water tank after each use and rinse with clean water.
- Wipe outer surfaces with a damp cloth.
- Avoid operating the appliance in humid or moist places.
- Do not locate the appliance near a heat source or direct sunlight.
- Always ensure the steam outlet hole is clean and free from scaling and not blocked.



This garment steamer is designed to use normal tap water.



For commissioning, general use and cleaning, please observe the instructions on pages 4-5 of this operating manual.

4 Troubleshooting

Problem	Possible solution
The steamer does not heat up	<ul style="list-style-type: none">• Check main plug is inserted correctly.• Check power supply.• Check power button.
The steamer does not produce steam	<ul style="list-style-type: none">• Check the water level and the water tank inlet cover is properly covered.• Press the steam activation button harder.• Hold the steamer in an upright position.
Water spills from the water tank	<ul style="list-style-type: none">• Make sure water is not over the MAXIMUM level.• Make sure water tank inlet cover is properly closed.
The steamer is producing a loud humming or pumping sound	<ul style="list-style-type: none">• Check water level; if there is no water or it is low, refill the water tank.
The steamer does not seem to be removing creases easily	<ul style="list-style-type: none">• Hold the steamer in an upright position and stretch the fabric downward to ensure best results.
Unsure when to use the brush	<ul style="list-style-type: none">• Use net brush on delicate fabrics and fabric brush on other subjects for better results.
Avoiding discoloring of metal accessories on the garment	<ul style="list-style-type: none">• Do not directly hover the garment steamer over the metal accessories.• Be cautious and steam around the metal accessories.